

Range: Brassware

Type: Thermostatic Douche Kit

Code: GF084 GF080 DI083 DI080 LN083 LN080 KN082 KN081 KN080 ET082 ET081 ET080

Version/Date: v1 12/23



Douche Valve is supplied with various handles depending on Range.

#### User Guide:

Please ensure that when this Douche kit is not in use that the isolating valve is turned in the off position. Failure to do this may lead to a build up of pressure in the head and hose causing a leak to occur.

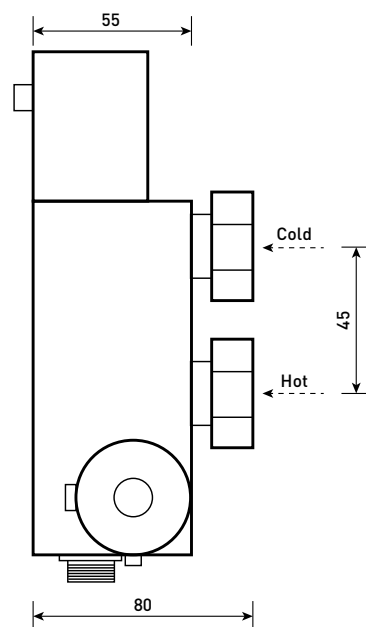
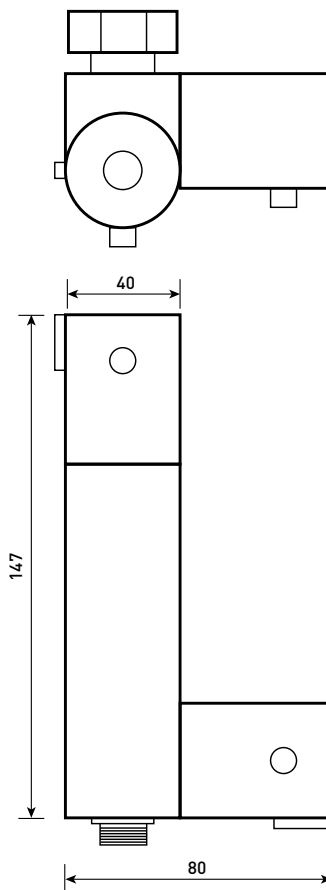
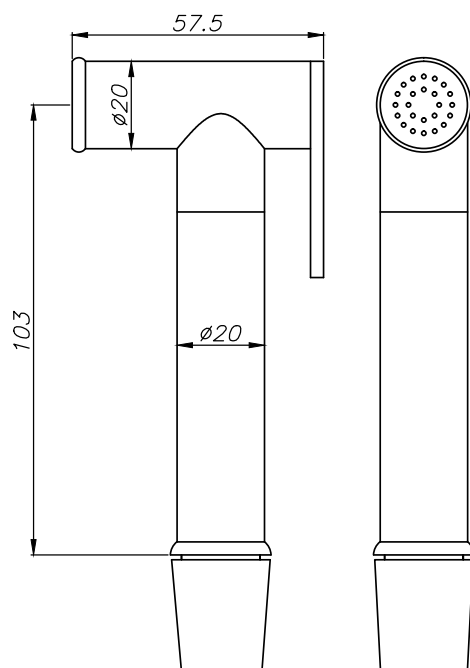

Bar	Litre/Min	38°C Litre/Min	Litre/Min
0.2	4.0	4.5	3.7
0.5	5.5	6.0	5.4
1.0	10.6	11.0	10.5
3.0	19.0	22.0	18.7

#### Finishes:



**Guarantee/Aftercare:** During installation extra care must be taken to avoid damaging the fittings. We provide a guarantee against faulty manufacture or materials (excluding serviceable parts), providing they have been installed, cared for and used in accordance with our instructions and good plumbing practice. All products installed in a commercial environment carry a 12 month guarantee. We cannot be held responsible for the use of incorrect dimensions shown for first fix without the actual products on site.

In line with the CE standards for this type of product, there may be a manufacturers tolerance of approximately +/- 2% on the overall dimensions and finish on these products. As per our terms and conditions of guarantee, we cannot be held responsible for the use of dimensions shown for first fix without the actual products on site. All dimensions stated are nominal and are subject to manufacturing tolerances.

Phoenix Whirlpools Ltd. Unit 8, Leeds 27 Industrial Estate, Bruntcliffe Ave. Morley, Leeds LS27 0LL

Tel: 0113 201 2260 Email: sales@phoenix-uk.com Web: www.phoenix-uk.com