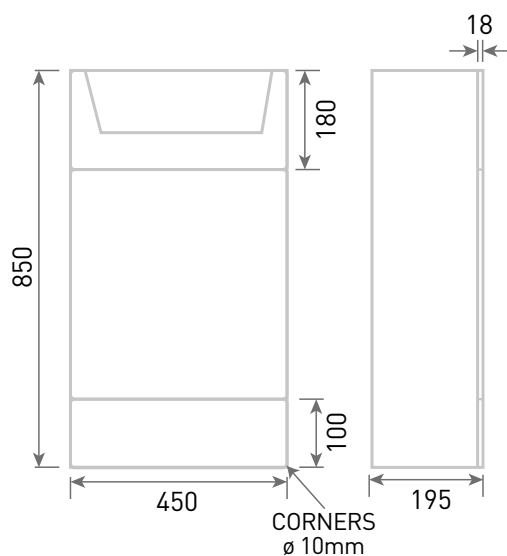
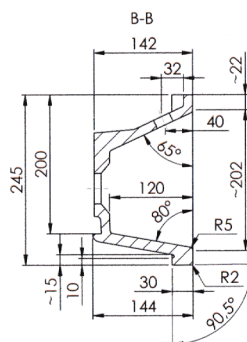
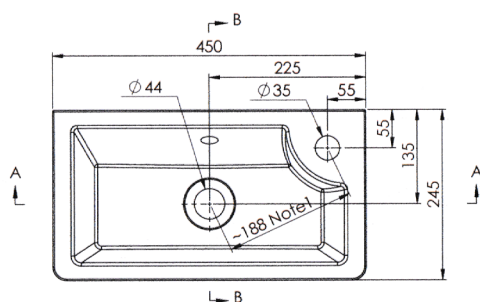
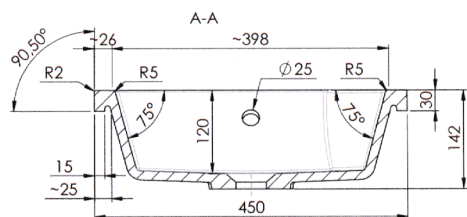

PHOENIX[®]

THE RETAIL BRAND

TECHNICAL DATA SHEET

Range: Arno Furniture**Type:** 45 Floor Standing 1 Door Unit & Mineral Cast Basin**Code:** N080164TH N080464TH N080564TH N080764TH**Version/Date:** v2 05/22**Information:**

Guarantee/Aftercare: During installation extra care must be taken to avoid damaging the fittings. We provide a guarantee against faulty manufacture or materials (excluding serviceable parts), providing they have been installed, cared for and used in accordance with our instructions and good plumbing practice.

Unit Colours:

Phoenix Whirlpools Ltd. Unit 8, Leeds 27 Industrial Estate, Bruntcliffe Ave. Morley, Leeds LS27 0LL

Tel: 0113 201 2260 Email: sales@phoenix-uk.com Web: www.phoenix-uk.com

Notes: Drawings may not be to scale. All dimensions in mm unless otherwise stated. Information correct at time of printing but subject to change at any time.