

Phoenix

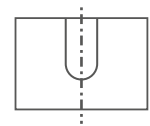

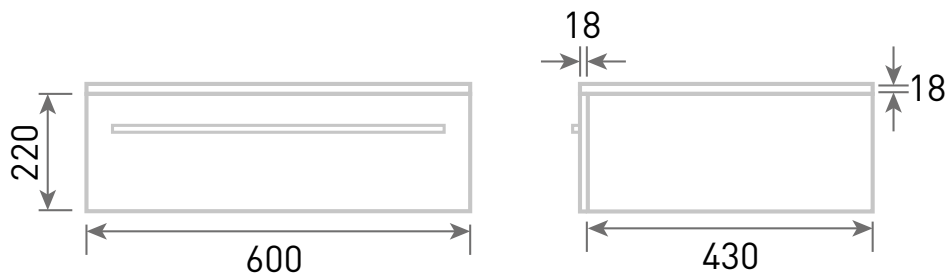

DESIGNED FOR YOU

Technical Data Sheet

Range: Furniture
 Type: Identity - 60 Drawer
 Code: N020906 N021306 N021106
 Version/Date: v2 04/21

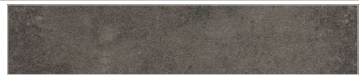
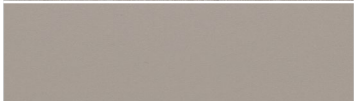
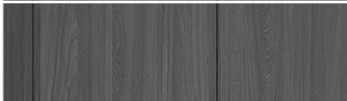

Centre waste position

Worktop Colour			
Side Colour			
	Light Concrete Stone Matt	Black Zebrano Black Zebrano	Metal Rock Matt Graphite

Guarantee/Aftercare: During installation extra care must be taken to avoid damaging the fittings. We provide a guarantee against faulty manufacture or materials (excluding serviceable parts), providing they have been installed, cared for and used in accordance with our instructions and good plumbing practice.

Phoenix Whirlpools Ltd. Unit 8, Leeds 27 Industrial Estate, Bruntcliffe Ave. Morley, Leeds LS27 0LL
 Tel: (Sales) +44 (0)113 2012260 Fax: +44 (0)113 2012268 Email: sales@phoenix-uk.co.uk Web: www.phoenix-uk.co.uk

Notes: Drawings may not be to scale. All dimensions in mm unless otherwise stated. Information correct at time of printing but subject to change at any time.