

## Towel Rail Installation

- . review instructions carefully before installation
- . installation should be completed by a suitably qualified person
- . please dispose of packaging in a responsible manner

### tools required

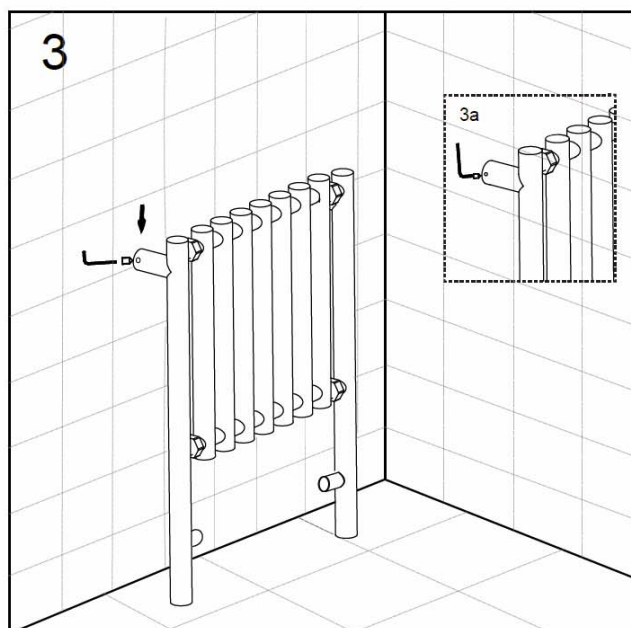
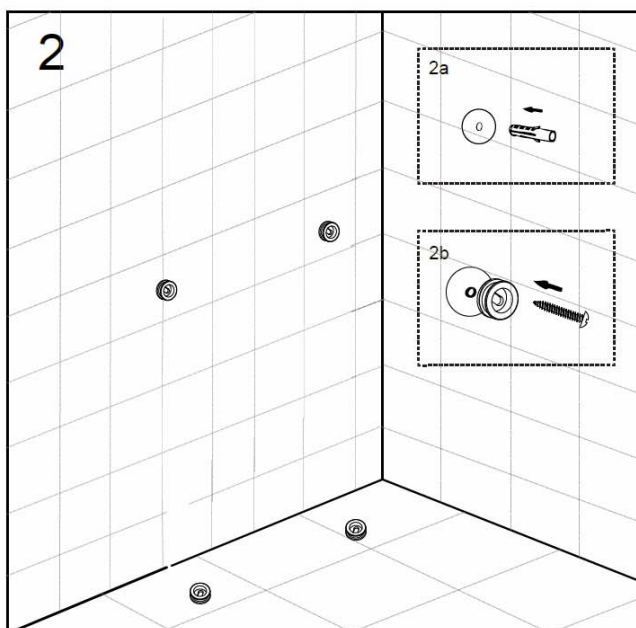
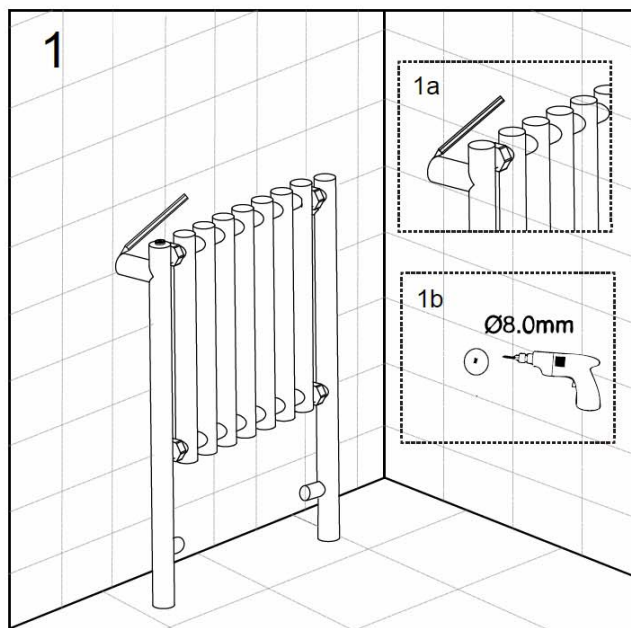
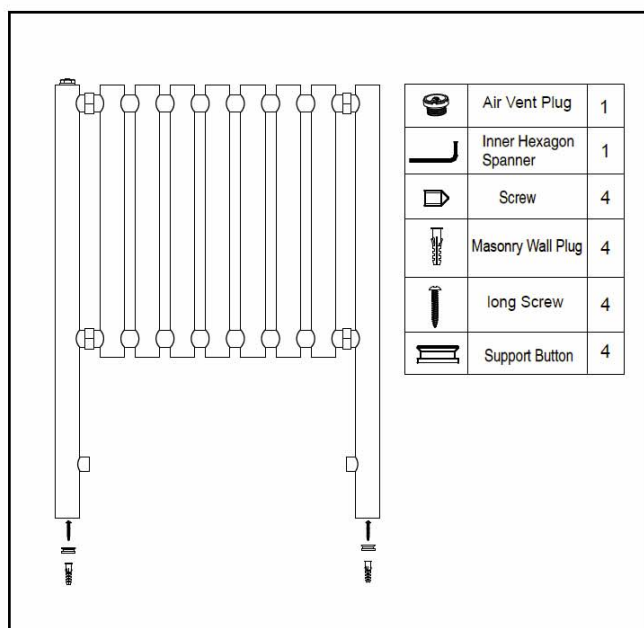
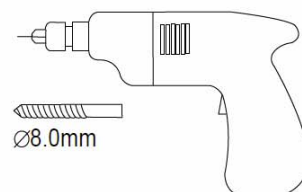
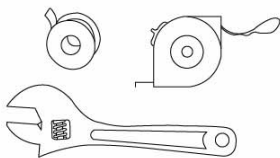
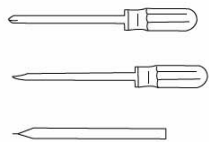

---

## WARRANTY

The warranty is subject to the product being installed in accordance with British Standards (BS5449:1990, BS7593:1992, BSEN12828:2003 and BSEN12831:2003) as well as directed by the installation instructions.

The manufacturer is not liable under this warranty:

For any defect arising from fair wear and tear, wilful damage, negligence, repair of the product without our approval or any use of or dealing with the product in a manner which could not reasonably be expected having a regard to the normal purpose.

Pinholes or defects caused by lack of corrosion inhibitor or other installation or system faults.

Any use of or dealing with the product in conjunction with any other item where such item causes or gives rise to the alleged defect.

The Retailers reserve the right to investigate all claims and conduct appropriate testing if deemed necessary. In all cases a proof of purchase will be required. In the event of a leaking product, the retailer must be contacted before the system is drained so that a water analysis can be carried out to establish the cause of the leak. If the claim is found to be valid by The retailer, subject to availability, a replacement will be issued within 21 working days. If the product line has since been discontinued, a similar replacement will be issued.

The retailers liability will under no circumstances extend beyond the repair or replacement of the product supplied by us.

Claims for refitting on any other consequential losses are not admissible. Any goods that are returned, in the event of a problem, will belong to the retailer. This warranty applies to the United Kingdom only and does not affect your statutory rights

IT IS ESSENTIAL THAT THIS TRADITIONAL TOWEL WARMER IS ONLY FITTED TO A STANDARD COMBI BOILER SYSTEMS OR OPEN VENTED SYSTEM , CORROSION INHIBITORS MUST BE USED.

This traditional towel warmer is warranted to be free from defect caused by faulty materials or workmanship for a period of 1 year from date of purchase. The surface finish of the radiator is warranted for the same period provided that no abrasive cleaners have been used, use only soapy water.

